



54 Harnham Road

Salisbury, SP2 8JJ

£345,000



This is a lovely terraced house originally constructed around 1900 of brick elevations beneath a tiled roof which has been recently refurbished and improved. The property has gas fired central heating as well as double glazed windows and the accommodation briefly comprises - sitting room, dining room and fitted kitchen with access to the court yard garden. On the first floor there are three bedrooms and a modern shower room. There is residents permit parking available on the road to the front.



Location

The property is located in Harnham an attractive and very popular area on the southern edge of the City. Excellent local facilities include a corner shop, hotel, public house, church, recreation ground and school. There is also a good local bus service running to the City centre. The famous Cathedral Close is also within walking distance as is the Market Square and all the facilities of Salisbury. These include a wide variety of shops and supermarkets, further schools and leisure facilities including a cinema and playhouse. Salisbury also has a main line railway station with connections to London Waterloo.

Sitting Room 13'2" x 12'0" (4.03m x 3.67m)

With fitted gas fire with marble style surround, bay window, television aerial point, telephone point, cable point, wood laminate flooring.

Dining Room 12'4" x 10'5" (3.76m x 3.20m)

With radiator, large storage cupboard with light, stairs leading off to first floor.

Kitchen 13'6" x 8'0" (4.14m x 2.45m)

With single drainer sink unit with drawers and cupboards below, plumbing and drainage for both dishwasher and washing machine, good range of base and drawer units with worktops over, fitted wall cupboards, Zanussi oven, recessed lights, radiator, space for fridge freezer. Door to side garden.

First Floor Landing

With access to loft space, storage cupboard, radiator.

Bedroom One 13'3" x 12'2" (4.05m x 3.72m)

With bay window and radiator.

Bedroom Two 12'2" x 7'11" (3.71m x 2.42m)

With radiator.

Bedroom Three 8'1" x 7'3" (2.47m x 2.23m)

With Worcester gas fired boiler, radiator, telephone point.

Shower Room

With modern twin shower cubicle, wash hand basin, WC, part tiled walls, electric light, shaver point, heated towel rail, fitted mirror.

Outside

To the front of the house there is a small area of garden with access to Harnham Road with its residents parking. There is side access to the small triangular court yard garden with a view of the Cathedral Spire.

Area Map

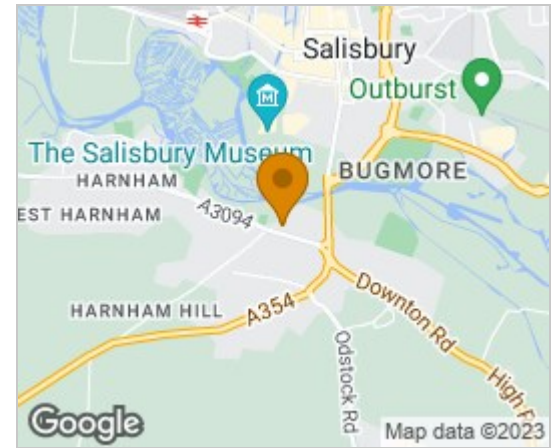

Floor Plans

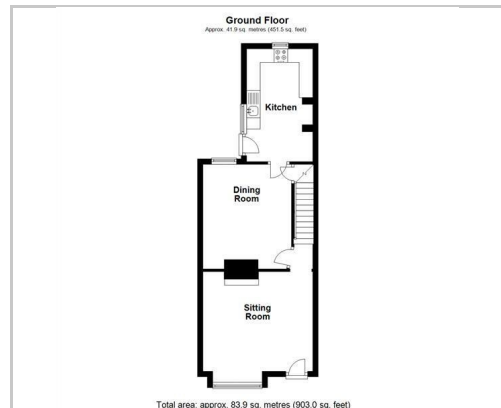
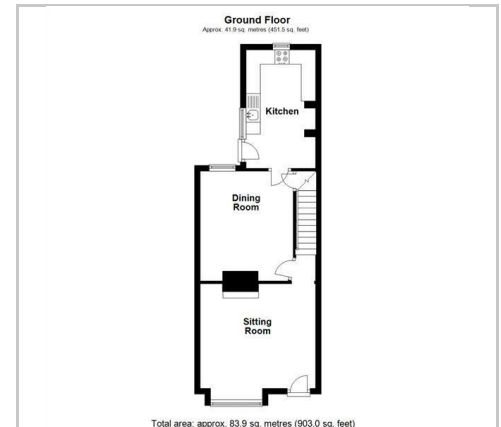

Energy Efficiency Graph

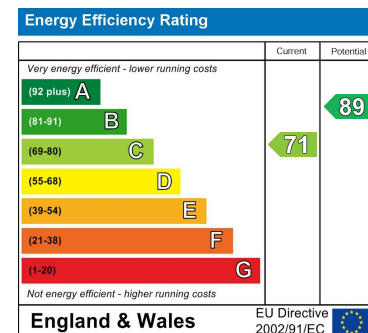

These particulars, whilst believed to be accurate are set out as a general outline only for guidance and do not constitute any part of an offer or contract. Intending purchasers should not rely on them as statements of representation of fact, but must satisfy themselves by inspection or otherwise as to their accuracy. No person in this firm's employment has the authority to make or give any representation or warranty in respect of the property.